

STRAIGHT; SPIN COUPLING

Supersedes MS3057-xxA

M85049	/41	-3A
SERIES	SLASH #	DASH #
	41: Straight	Table A

* All QPL M85049/41 backshells are offered in cadmium.

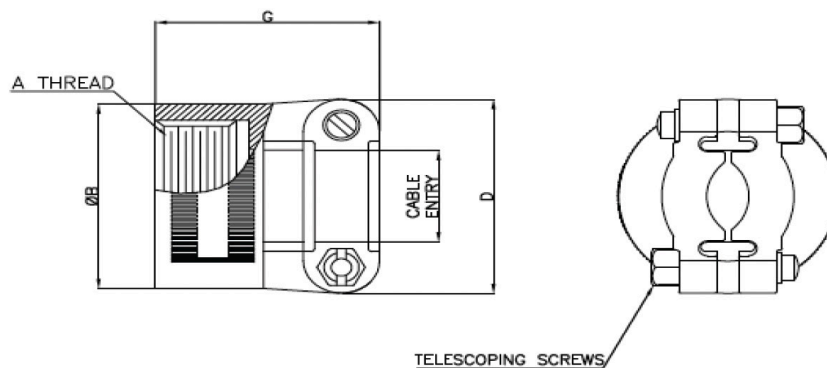

DASH #	Connector Shell Size	A Thread.	D Max.		E Max.		F Max.		G Max.		Cable Entry	
			inch	mm	inch	mm	inch	mm	inch	mm	inch	mm
3A	8 10	0.500-28 UNEF-2B	0.406	10.3	0.688	17.5	0.812	20.6	0.812	20.6	0.25	6.4
4A	10, 12, 12	0.625-24 UNEF-2B	0.406	10.3	0.812	20.6	0.875	22.2	0.812	20.6	0.312	7.9
6A	14, 14	0.750-20 UNEF-2B	0.406	10.3	0.969	24.6	1.062	27.0	0.875	22.2	0.438	11.1
8A	16, 16	0.875-20 UNEF-2B	0.406	10.3	1.094	27.8	1.156	29.4	0.938	23.8	0.562	14.3
10A	18	1.000-20 UNEF-2B	0.406	10.3	1.188	30.2	1.250	31.8	0.938	23.8	0.625	15.9
12A	20, 22	1.188-18 UNEF-2B	0.406	10.3	1.375	34.9	1.469	37.3	0.938	23.8	0.750	19.1
16A	24, 28	1.438-18 UNEF-2B	0.406	10.3	1.656	42.1	1.688	42.9	1.031	26.2	0.938	23.8
20A	32	1.750-18 UNS-2B	0.469	11.9	2.031	51.6	2.031	51.6	1.094	27.8	1.250	31.8
24A	36	2.000-18 UNS-2B	0.531	13.5	2.219	56.4	2.281	57.9	1.156	29.4	1.375	34.9
28A	40	2.250-16 UN-2B	0.531	13.5	2.500	63.5	2.688	68.3	1.688	42.9	1.625	41.3
32A	44	2.500-16 UN-2B	0.594	15.1	2.781	70.6	2.938	74.6	1.750	44.5	1.875	47.6
40A	48	3.000-16 UN-2B	0.656	16.7	3.281	83.3	3.500	88.9	1.750	44.5	2.375	60.3